

HEWLETT-PACKARD

Integral Personal Computer Setup Guide



**Preparing Your HP Integral PC for Use
(includes starting the tutor program) 2**

Installing Print Head Cartridge 4

Loading Fanfold Printer Paper 6

Preparing Your HP Integral PC for Moving 8

HP Computer Museum
www.hpmuseum.net

For research and education purposes only.

Preparing Your HP Integral PC for Use (includes starting the tutor program)

1. AVOID DAMAGE.

If voltage switch doesn't agree with line voltage, refer to Chapter 1 in the User's Guide.

2. Check voltage.

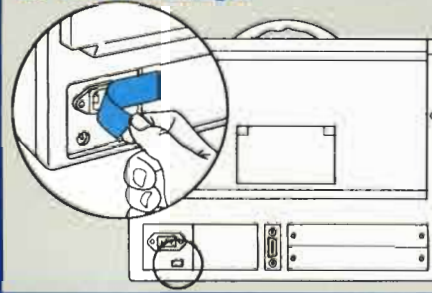

3. 115V

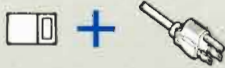

=OK

230V



=OK

4. Unlatch top.

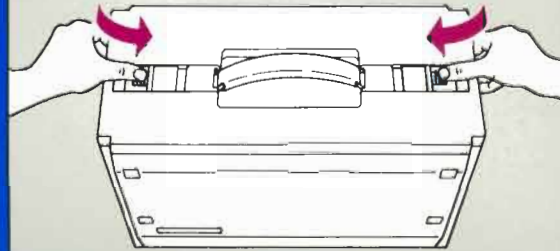

5. Open top.

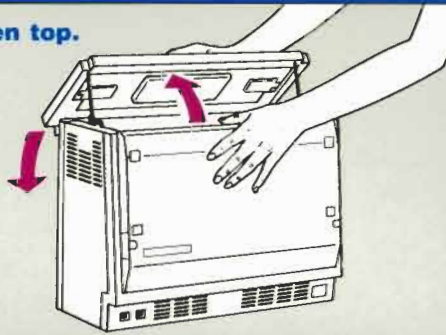

6. Remove keyboard.

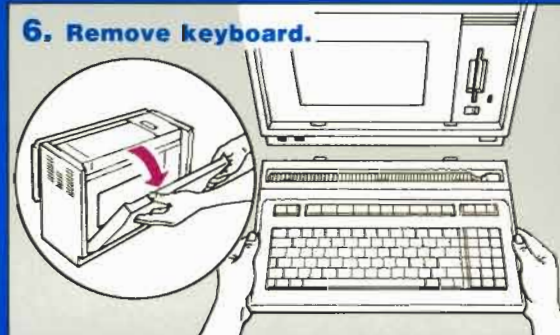

7. Extend legs.

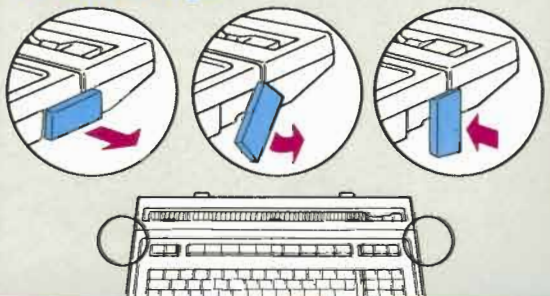

8. Connect keyboard.

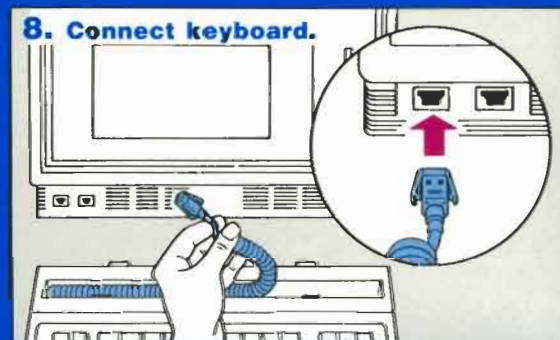

9. Connect optional mouse.

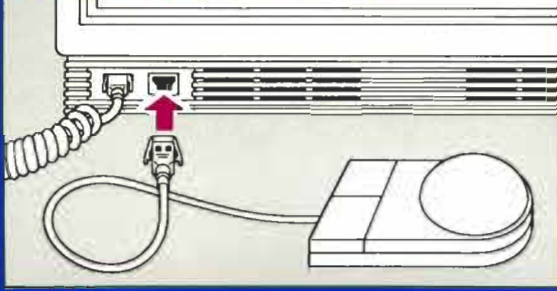

10. Connect power.

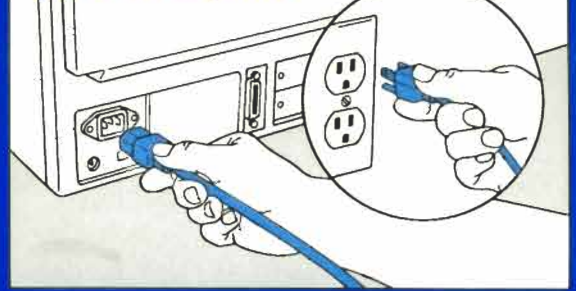

11. Remove shipping protection.

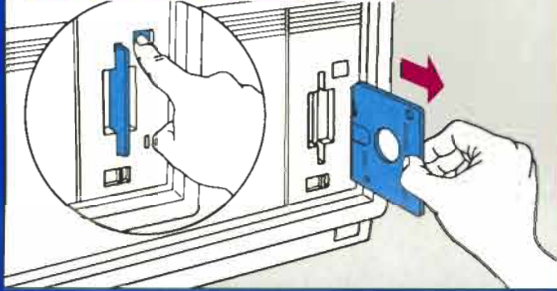

12. Insert tutor disc.

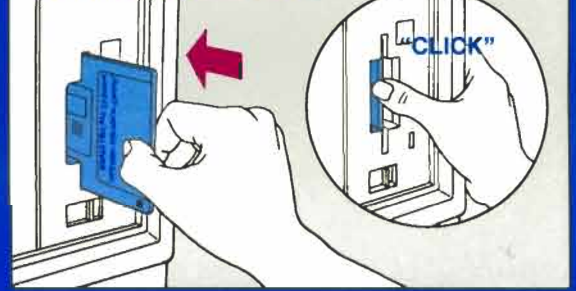

13. Power on.

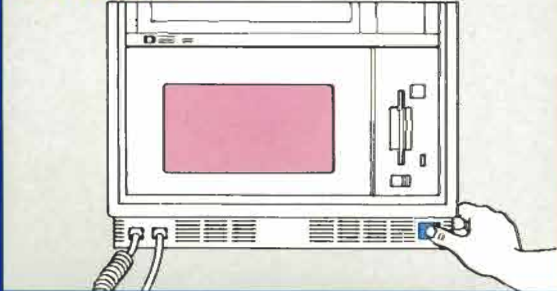

14. See self-starting tutor begin.

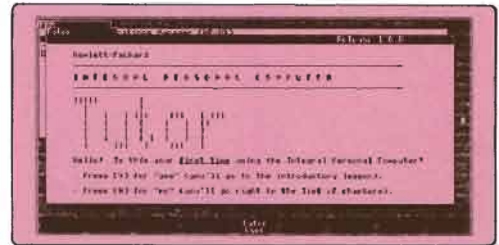

15. Adjust screen angle.

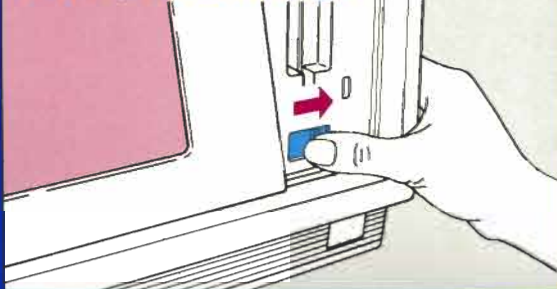

16. Problems? Refer to User's guide.



Installing Print Head Cartridge

1. Open lid.

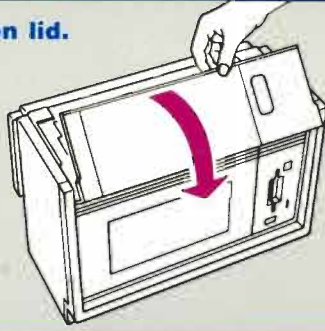

2. Close arm.

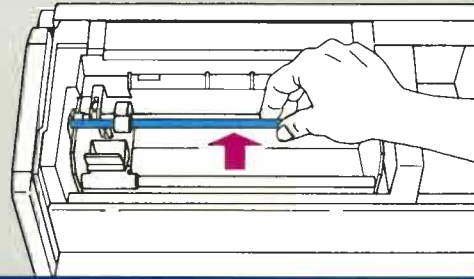

3. Open latch.

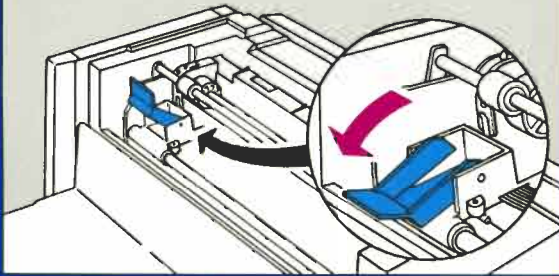

4. Open printhead cartridge container.



5. Remove cartridge.



Do not touch
metallic surface
on cartridge.



6. Extra absorber not needed now.*



* Replace ink
absorber when you
replace cartridge.
For instructions,
refer to User's Guide,
Appendix A.

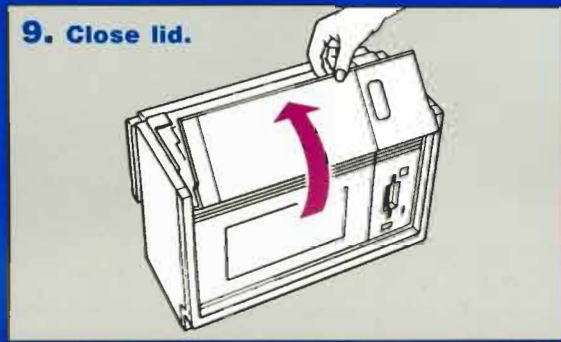
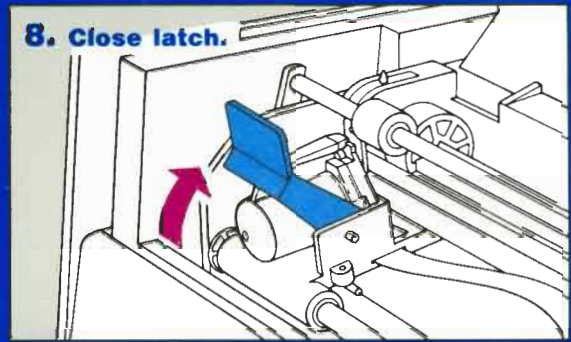
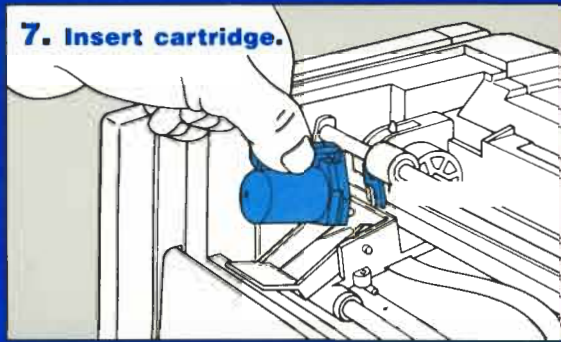

Loading Fanfold Printer Paper

1. Power on.

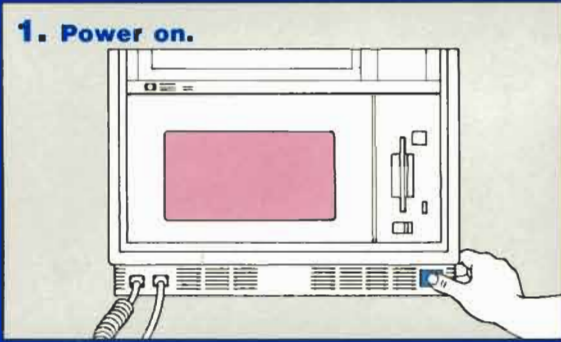

2. Open lid.

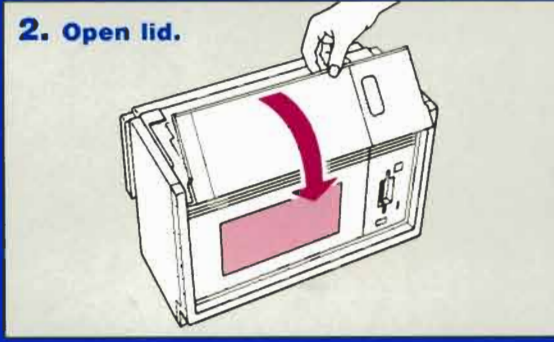

3. Open arm.

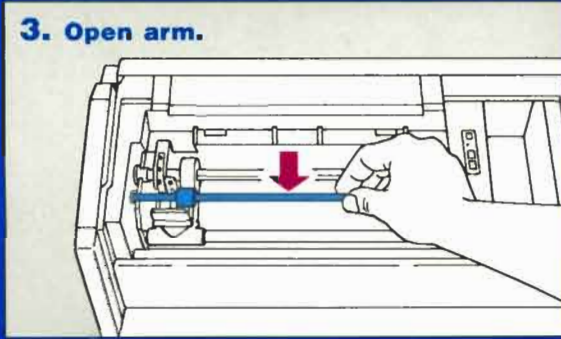

4. Insert paper.

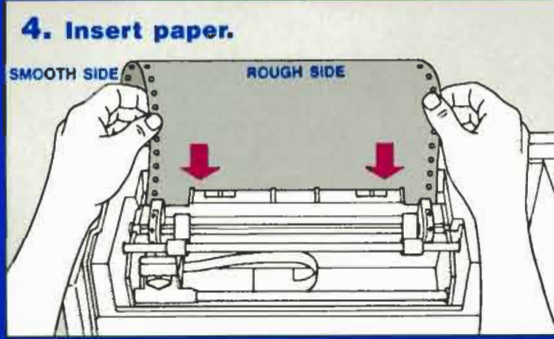

5. Feed paper.

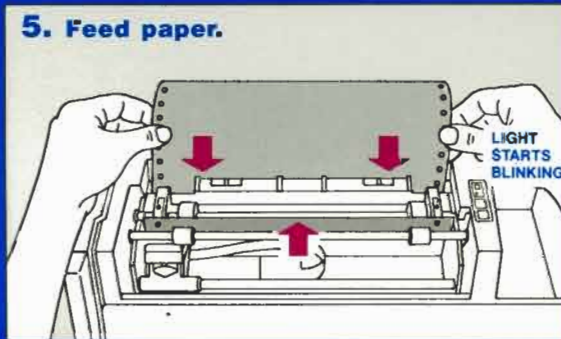

6. Align left holes.

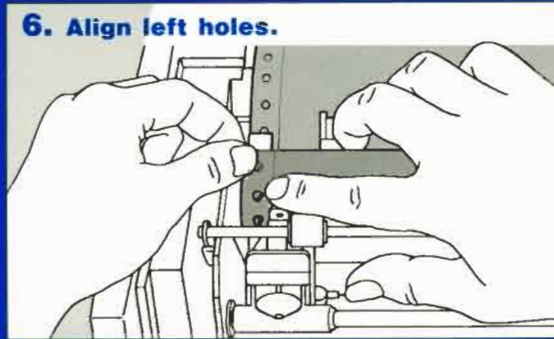

7. Align right holes.

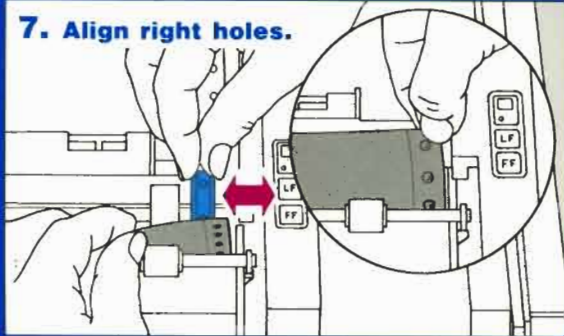

8. Close arm.

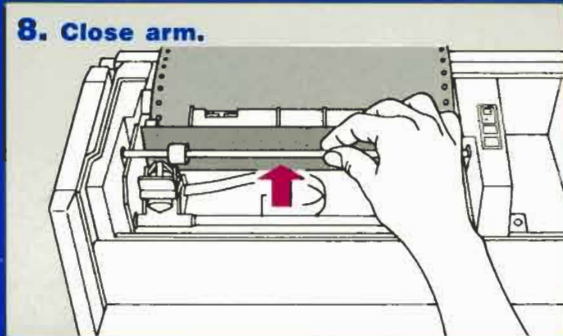

9. Press LF until ...

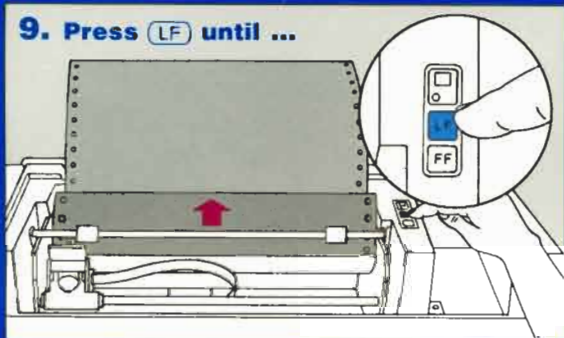

10. ... page separation is here.

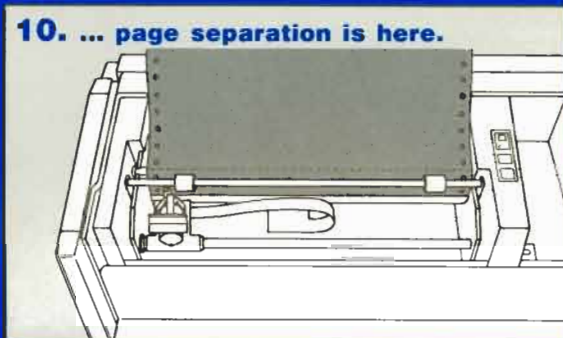

11. Set top-of-form.

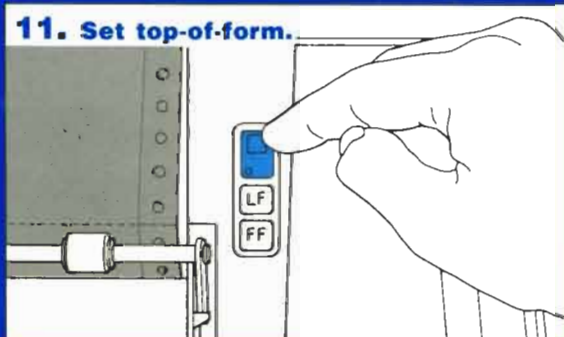

12. Close lid.

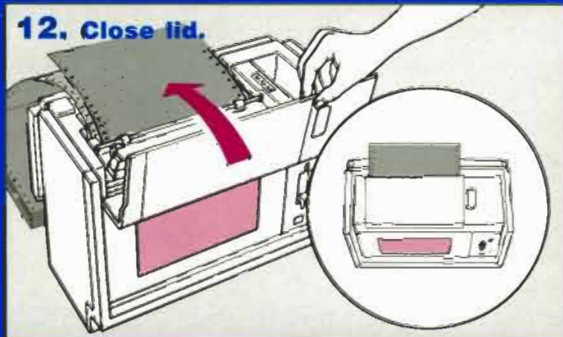

Preparing Your HP Integral PC for Moving

1. Tear off unused paper.

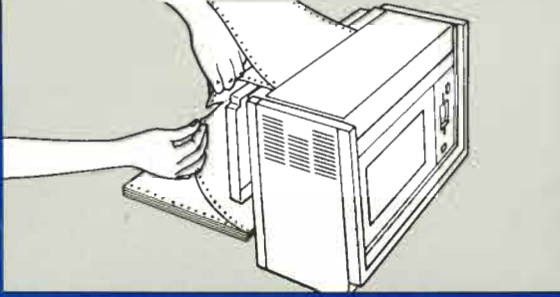

2. Power on, press (FF).

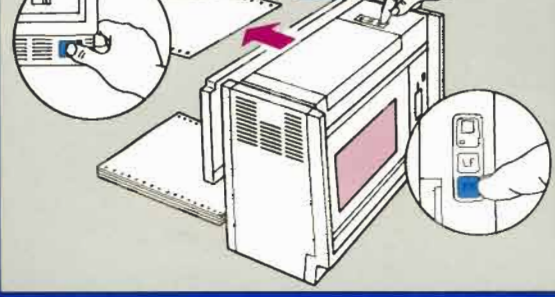

3. Remove disc.

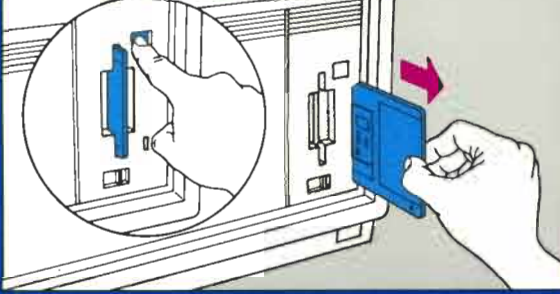

4. Power off.

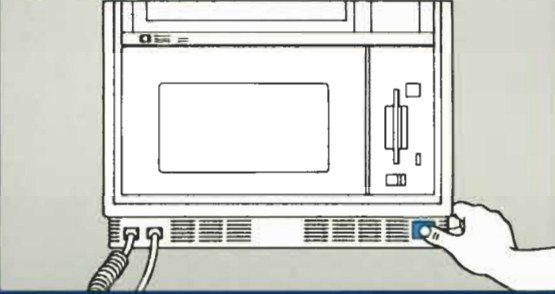

5. Insert shipping protection.

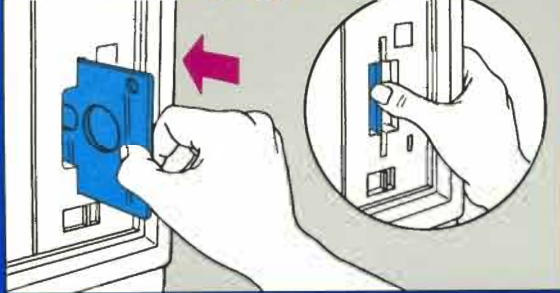

6. Disconnect power.

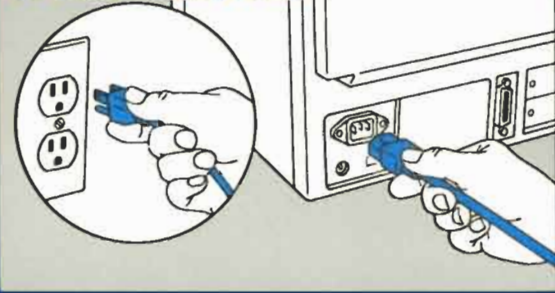

7. Open lid.

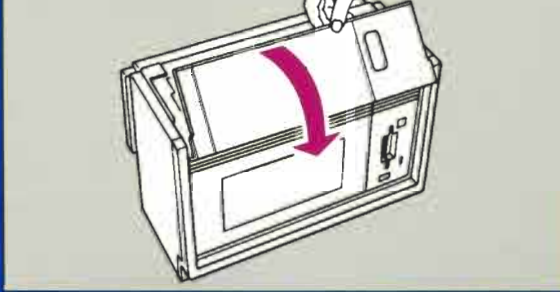

8. Store disc and cord.

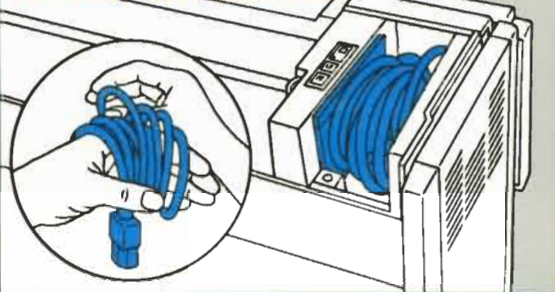

9. Close lid, push display in.

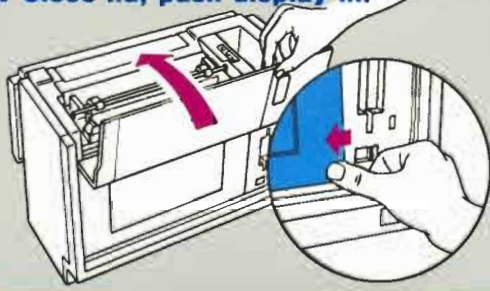

10. Disconnect cable(s).

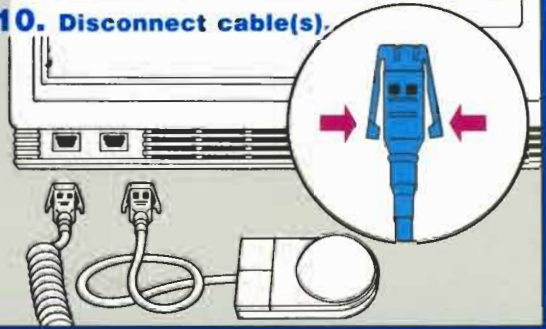

11. Store keyboard cable.

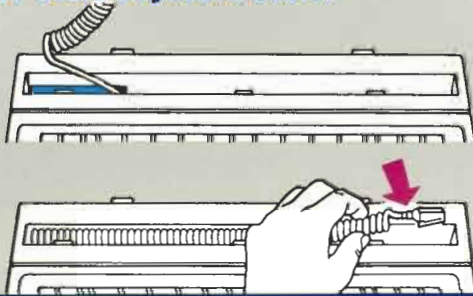

12. Retract legs.

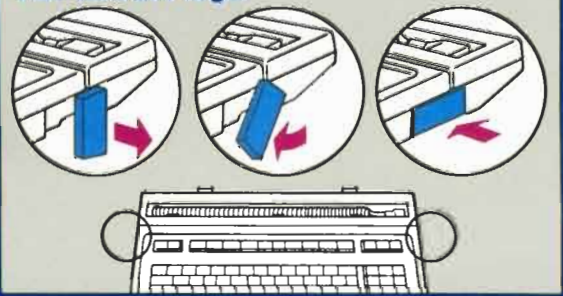

13. Store keyboard.

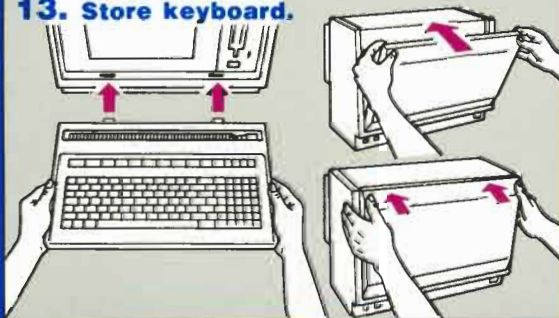

14. Do not open printer lid.

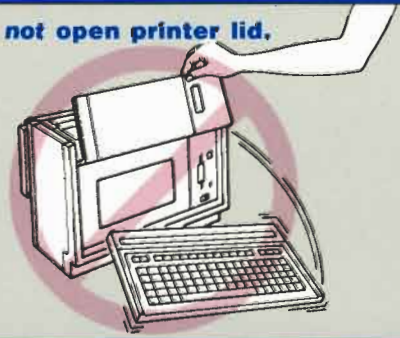

15. Close and latch top.

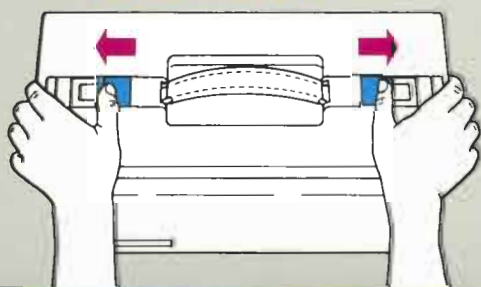

16. Do not check as airline baggage.





HEWLETT
PACKARD

Reorder Number
00095-90087

Mfg. No. 00095-90106
Printed in U.S.A.