HP 150 Memory Accessory Board

Installation Instructions

This packet contains installation and testing instructions for your new Memory Accessory Board for the HP 150 Personal Computer. Insert these pages in the section on "Accessory Boards" in Chapter 2 of the *HP 150 Personal Computer Owner's Guide*.

NOTE

Accessory boards may be damaged by static electrical charges occurring naturally in your work environment. Therefore, it is important that you follow these instructions as closely as possible for installing your memory accessory board.



Hewlett-Packard Co.
Personal Office Computer Division
974 East Arques Avenue
P.O. Box 486
Sunnyvale, CA 94086

Part No. 5957-8762
Printed in U.S.A. 9/83



Installing A Memory Accessory Board

This section outlines how to install a memory accessory board in your HP 150.

NOTE

Accessory boards may be damaged by static electrical charges occurring naturally in your work environment. Therefore, it is important that you follow the directions as closely as possible for installing an accessory board.

There are two slots available in the rear panel of the HP 150 for installing accessory boards. Any accessory board with the letters RAM indicated beside the part number must be loaded in accessory slot #1 in the rear panel of your system processor.

The following steps outline how to install your memory accessory board.

NOTE

It is important to verify that the system processor recognizes all the memory loaded into the system. Therefore, before you install a memory accessory board into your system processor, you should first run a memory self-test (outlined later in this section).

After you install the memory accessory board, run the test again to be sure the new total amount of memory is recognized.

1. Turn the power switch OFF for your system processor, but leave the power cord installed. For ease of installation, you may wish to disconnect cables for your peripherals (disc drives, printers or plotters).

2. Remove the standard plate on the rear panel of your HP 150 covering the accessory slot you wish to use by unscrewing the captive fastener. (These fasteners are designed to remain attached to the cover plate). This plate will be used to cover the rear panel once the memory accessory board is installed.

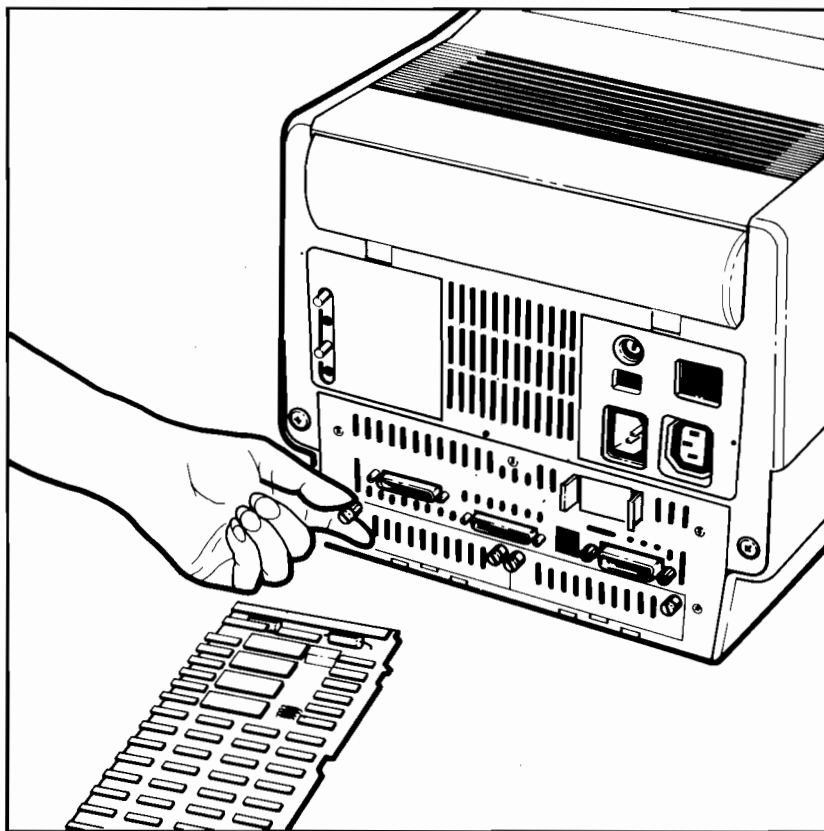

3. Take the memory accessory board out of the package, taking care to handle the accessory board by the edges only. Save the conductive plastic bag for future use.

HP Computer Museum
www.hpmuseum.net

For research and education purposes only.

4. Holding the edges, slide the memory accessory board (with components facing up) into the accessory slot. Notice that the corner plastic pieces are in such a position to allow the accessory board to align the guides inside the accessory slot in your HP 150.

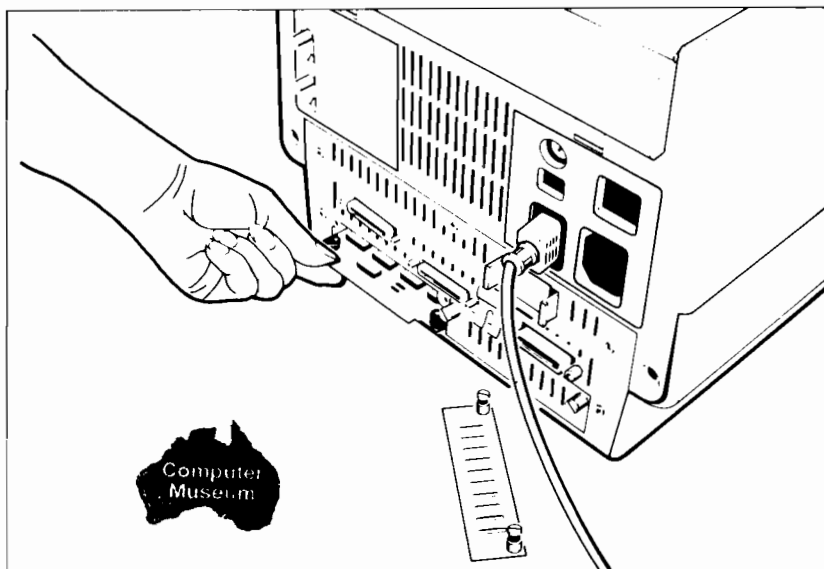

5. To cover the accessory slot:
 - a. Place the cover plate you just removed from the rear panel over the accessory slot on the rear panel.
 - b. Align the fastener on the cover plate with the holes on the rear panel.
 - c. Press the captive fastener in on one side of the cover plate so that the spring action is held down while you turn the fastener to tighten. Repeat for the other side of the cover plate.
6. If you removed any cables connecting your peripherals, reconnect them at this time.

How Do I Remove A Memory Accessory Board?

Should you wish to remove an memory accessory board, simply follow the steps below.

1. Turn your system OFF but leave the power cord installed. For ease of removing the memory accessory board, you may wish to disconnect cables for your peripherals.
2. Remove the cover plate on the rear panel of your HP 150 covering the accessory slot by unscrewing the captive fastener. (These fasteners are designed to remain attached to the accessory cover plate).
3. Push the black plastic pieces at the corners of the accessory board away from the center of the board. The pivot action of the plastic pieces will start sliding the board out from the card guides in the accessory slot.

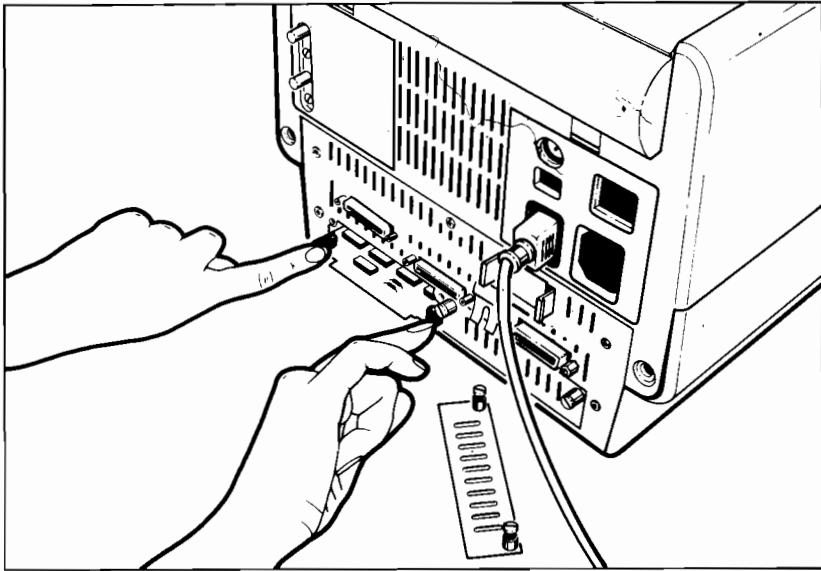

- Place the memory accessory board in the conductive plastic bag in which it was shipped. Remember to handle the board by the edges only!
- Cover the accessory slot on the rear panel of the HP 150 with the cover plate.

CAUTION

Be sure to replace the cover plate over the accessory slot on the rear panel; otherwise, electrical interference with other equipment may occur.

How Can I Be Sure the Memory Accessory Board Works?

To test whether or not the HP 150 recognizes additional memory that you may install, a memory self-test has been designed into your system processor.

Before installing the memory accessory board, you should have run the memory self-test as outlined below. After installing the memory accessory board, run the memory self-test again.

- Push **User System** twice to display the following:

```
device margins/ service modes enhance define set config
control tabs/coll keys keys video fields time keys
```

- Press **service keys** to display the following:

```
POWER ON MEMORY TOUCHSEN SYSTEM IDENTIFY DATA/COMM
TEST TEST ALIGNMNT TEST TEST ROMS TEST
```

CAUTION

Pressing **MEMORY TEST** performs the same function as a hard reset, which causes a total data loss. In order to test all memory functions, be sure to store any data first.

The screen clears completely, and the following message is displayed in the bottom left side of the screen:

```
Testing
0 1 2 3 ( 4 5 6 7 8 9 ) (optional in parentheses)
```

A inverse video block highlights each number as it is tested. The numbers indicate the amount of memory installed in your HP 150, as follows:

Numbers Listed	Total Memory Available
0 to 3	256K (Standard)
0 to 5	256K plus 128K EXT RAM Acc Bd = 384K total
0 to 7	256K plus 256K EXT RAM Acc Bd = 512K total
0 to 9	256K plus 384K EXT RAM Acc Bd = 640K total

If all memory boards pass self-test, the screen clears and the system resets.

If an error occurs, the following message is displayed:

```
Memory test failed 0 X Y Y (Error Code)
Press RETURN to clear
```

The code following the message "Memory test failed" indicates the memory board(s) within your HP 150 which may have failed, as well as the location of the failure.

NOTE

Be sure to write down this code so that your service representative can identify the memory board to be corrected.
